

# dyson supersonic

## User manual



---

In the box

Getting started

LEDs

Using your hair dryer

Regular filter cleaning

# In the box

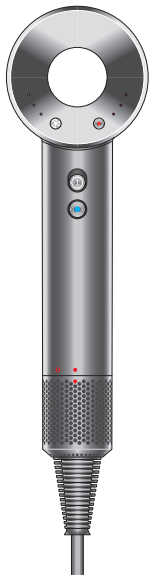

Dyson Supersonic™  
hair dryer

---

Some attachments may not be included.

You can buy additional attachments at [www.dyson.com](http://www.dyson.com).

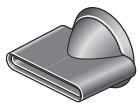

Styling concentrator



Gentle air attachment



Diffuser

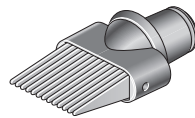

Wide-tooth comb

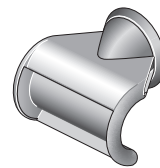

Flyaway attachment

# Getting started

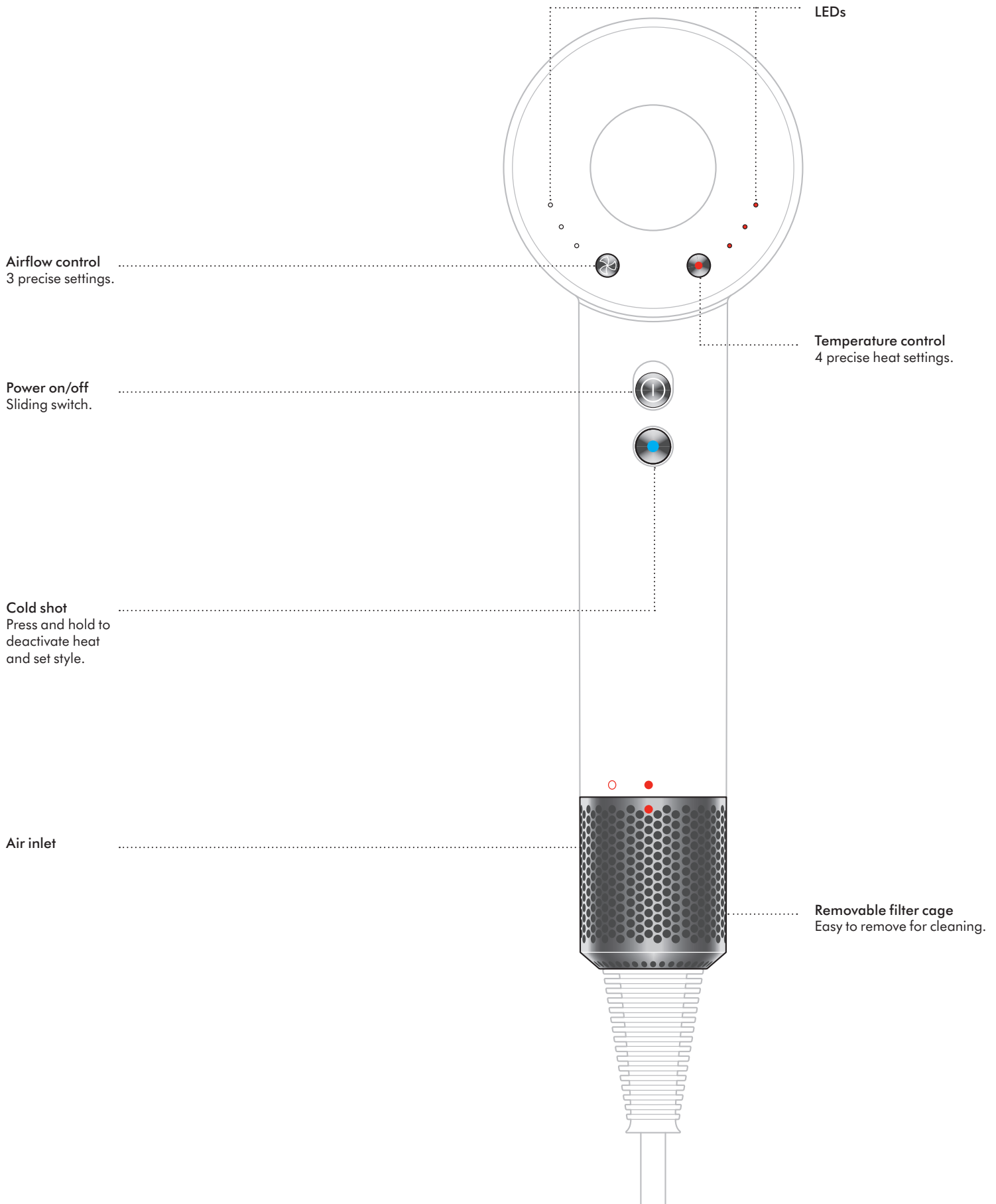

# LEDs

---

## Settings

The LED lights indicate which settings you are using.

### Flow

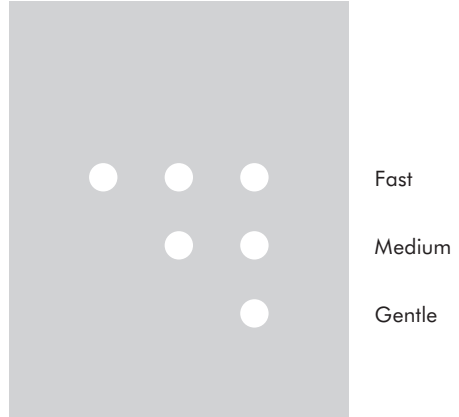

---

## Temperature

Maximum operating temperature in normal working conditions: 105°C.  
Maximum thermistor temperature at safety shut down: 145°C.

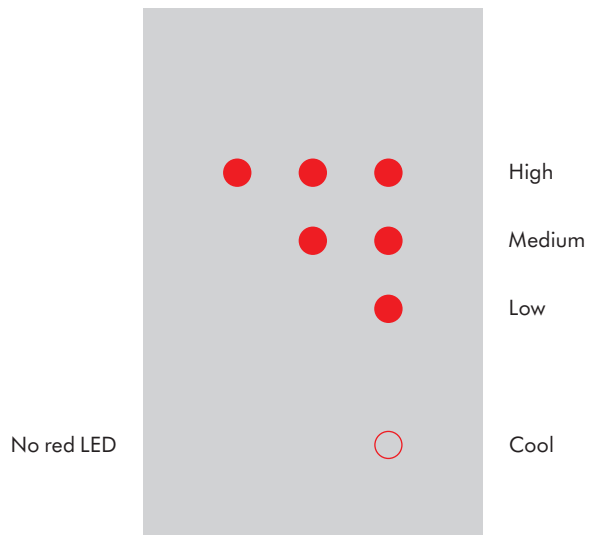

---

## Diagnostics

The LEDs will flash continuously to let you know that your machine needs attention.

Clean the filter. Follow the instructions or watch the video at [dyson.com/yoursupersonic](https://www.dyson.com/yoursupersonic).

If all three red lights continue to flash, contact the Dyson Helpline.

Don't turn back on.

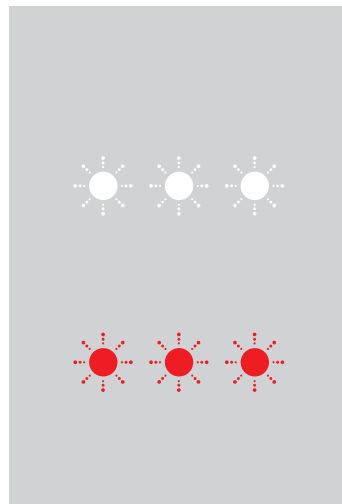

# Using your hair dryer

Your Dyson Supersonic™ hair dryer has magnetic styling attachments, for easy fitting and rotation during styling.

Remove your attachments using the cool edges.

Heat Shield technology keeps the surface of your styling attachments cool.

---

## Smoothing nozzle

Helps create volume and body. Decreases frizz for a smooth, natural look.

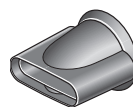

## Styling concentrator

Wider and thinner for precision styling.

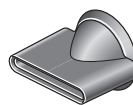

## Diffuser

Even diffusion to help define curls and reduce frizz.



## Gentle air attachment

Cooler, gentle drying for fine hair and delicate scalps.



## Wide-tooth comb

Engineered for curly and coily hair. Lengthen hair completely, or tease out curls just a little bit.

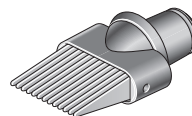

## Flyaway attachment

For a smoother finish. Attracts longer hairs and hides flyaways, using the Coanda effect.

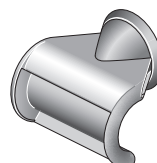

# Regular filter cleaning

Check your filter is clear from hair product residue and debris monthly, or when the LED lights alert you.

## Maintaining performance

Unplug your machine from the mains electricity supply and allow to cool down before cleaning your filter.

The Dyson Supersonic™ hair dryer has highly tuned technology to give outstanding performance.

This technology needs to be kept free from dust and hair product residue. Maintenance is required to maintain performance.

### Step 1

Hold the handle of your machine firmly and gently rotate the filter cage anti-clockwise.

### Step 2

Pull down and away from the machine. Use a lint-free cloth or soft brush to remove any dust or debris from both the filter cage and the filter mesh.

### Step 3

Don't use water to clean the filter mesh.  
Don't apply too much pressure to the filter mesh.

### Step 4

Rotate the filter cage back into position until correctly aligned.

Rotate clockwise to lock before use.

