

# clean+wash

## Hygiene

### User manual

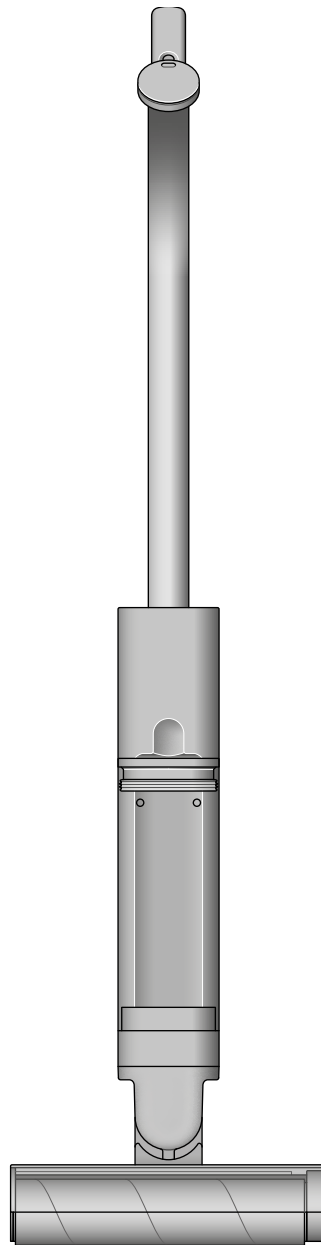

---

#### Contents

In the box

Download the MyDyson™ app

Getting started

The LCD screen

Quick start

How to clean

Self-cleaning and daily maintenance

Regular maintenance

Deep-clean maintenance

Battery and performance tips

Disassemble your machine

Troubleshooting

Support and service

# dyson

# In the box

Your machine is boxed in two parts:

1. Machine body
2. Handle

Simply attach the handle to the main body.

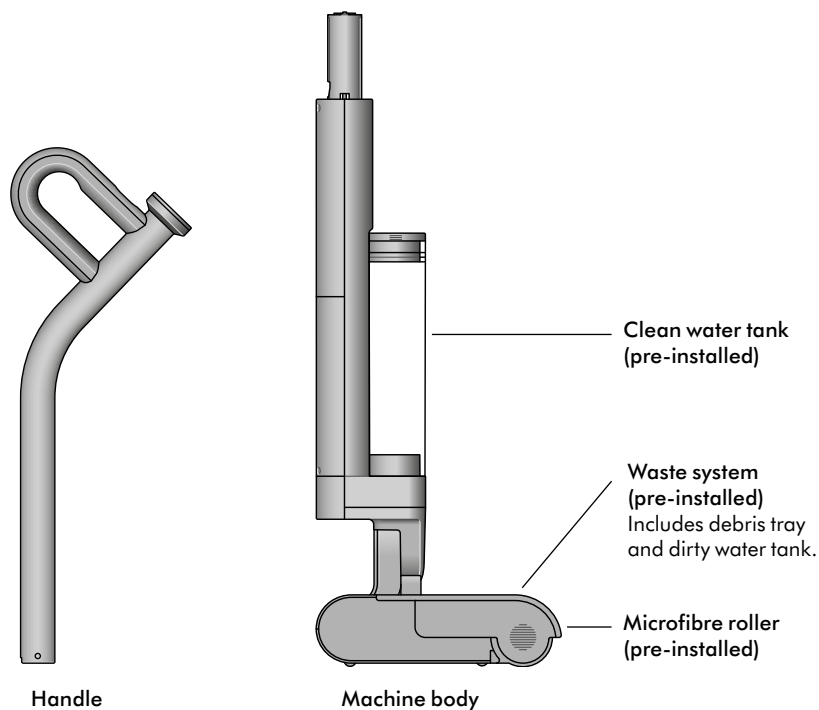

02 Probiotic cleaning solution

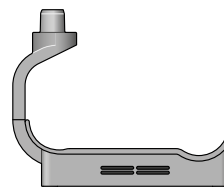

**Hot-air drying dock**

One-piece charging dock with plug.  
The Dyson Clean+Wash Hygiene Hot-air drying dock charges, cleans, and hot-air dries the machine on the dock.

## Download the MyDyson™ app

Download the MyDyson™ app from the App Store or Google Play.  
Open the app and follow the on-screen instructions to create a new account.



Apple, the Apple logo, and Siri are trademarks of Apple Inc. App Store is a service mark of Apple Inc. Google Play, the Google Play logo, Google Assistant are trademarks of Google Inc.

# Getting started

Get to know your machine's controls

Hydration modes

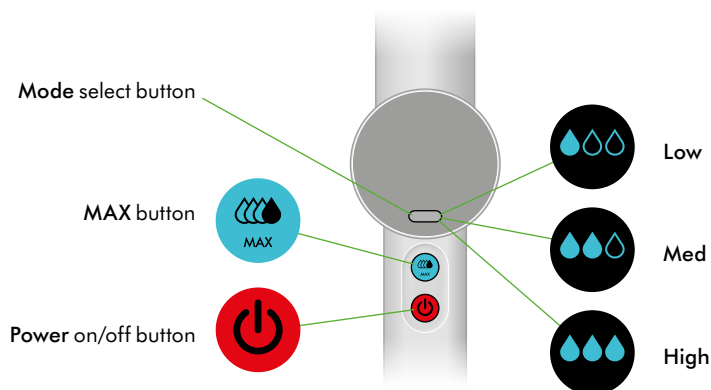

1. Click the wand into the main body until it locks in place.

2. Wake the machine by pressing any button. Press and hold the mode select button to set your desired language.

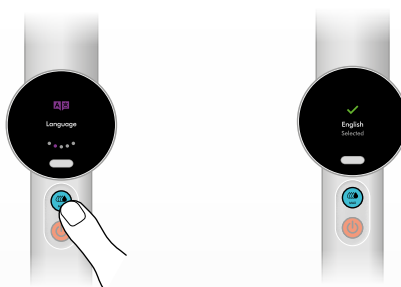

3. Download the MyDyson™ app from the App Store or Google Play via QR code shown on screen.



4. Register your machine using the serial number (located behind the battery pack).

5. Place your Clean+Wash Hygiene on the charging dock and fully charge before first use.

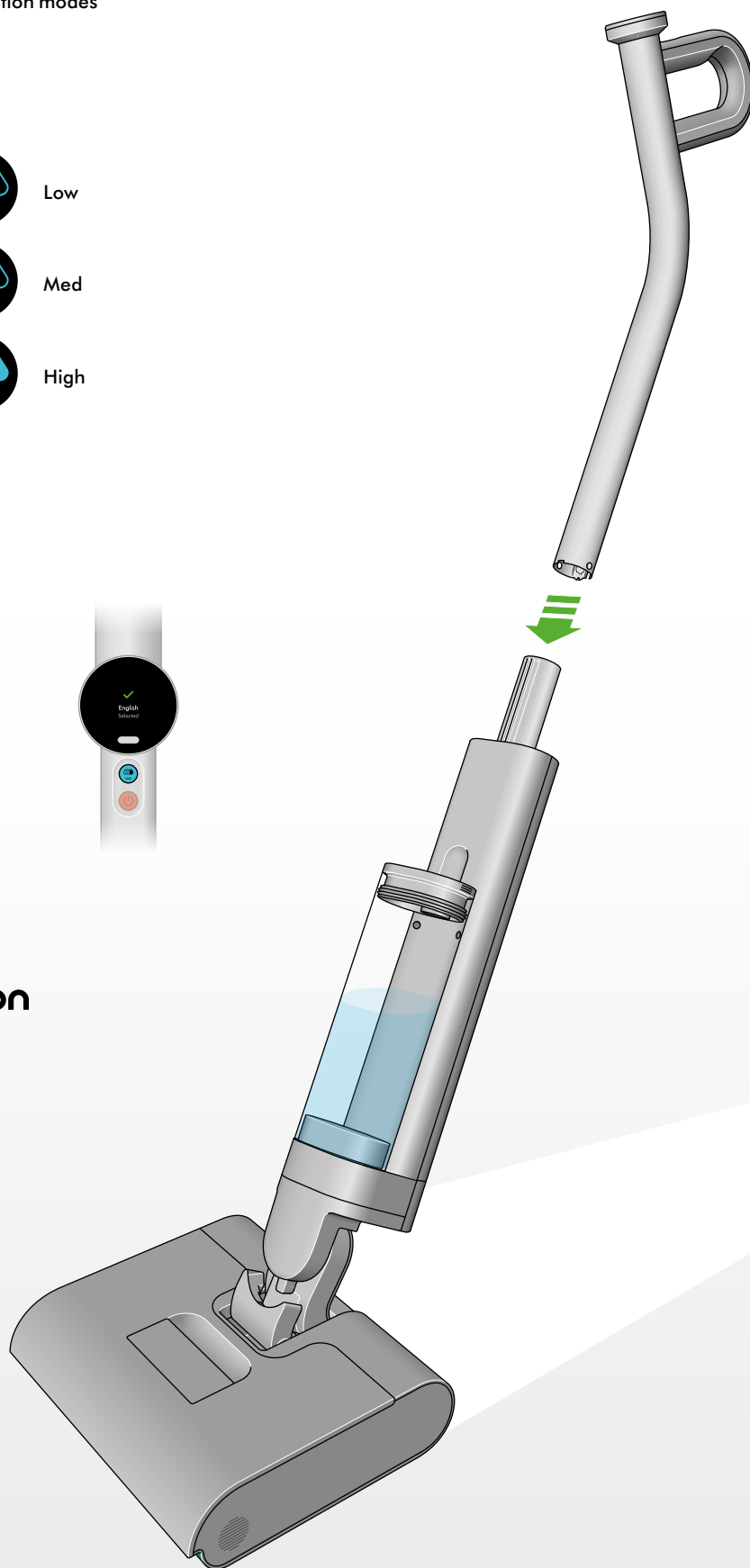
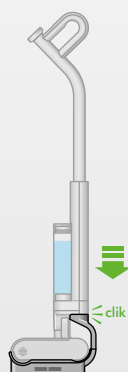

# The LCD screen

The LCD screen displays helpful performance information such as the selected mode, remaining run time and essential maintenance alerts.

## Cleaning

Use the Mode button to select mode. Press start to begin cleaning.

### Choose the mode to suit the task

Water droplet icons indicate power modes: Low, Med, High, MAX.

#### Low mode (Least water applied)

For dust, hair and liquid spills

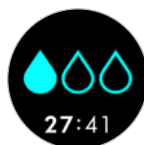

#### Med mode

For dry debris and thicker spills.

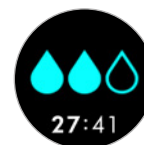

#### High mode

For oils, sticky spills and stains.



#### MAX mode (Most water applied)

Press and hold the MAX button for the most stubborn stains and dirt.

Tip: Use MAX sparingly to preserve battery life.



## Alerts

### Empty dirty water tank

When your dirty water tank is full, you will be prompted with an alert on the screen.



### Roller stuck

You will be prompted with this alert if something is stuck between the roller and the squeegee, or if your roller is not attached correctly.



## Self-cleaning and Hot air drying

### Self-cleaning in progress

Shows when self-clean is operating.



### Hot-air drying progress

Shows when hot-air drying is operating.



### Self-clean awaiting

When machine is below 30% battery, the self-clean cycle will be disabled. Place the machine on the dock to charge.

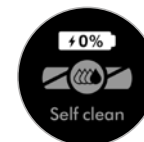

## Replacement rollers

We recommend replacing your microfibre roller at around 6 months, depending on usage. The machine will alert you when they need to be changed – and display a QR code for ordering replacements. When fitting a new roller, reset the lifetime counter.



## Run time

The LCD screen constantly displays the machine's remaining run time underneath the water droplet icon – so you'll always know how much cleaning time you have left.

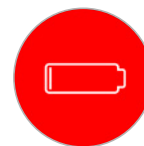

Your Dyson Clean+Wash Hygiene hard floor cleaner runs on a battery with up to 45 minutes charge. Low battery alert will be shown when remaining run time is low.



# Quick start

## Remove the clean water tank

Press the release button and lift the clean water tank away from the machine.

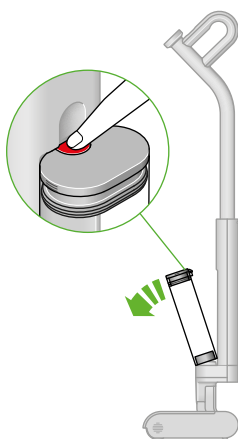

## Fill the clean water tank

Open the lid and fill to the MAX line with clean water, or just under if adding cleaning solution (Max 60°C).

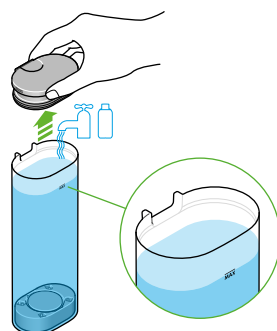

## Add cleaning solution

Add 20ml of O2 Probiotic hard floor cleaner.



## Close and replace the clean water tank

Close the lid and reconnect the tank to the body of the machine.



## Allow roller to fully hydrate

For first use, allow 5 minutes for the roller to fully hydrate. For subsequent uses allow 10 seconds.

# How to clean

## Position your machine

Take the machine off the dock. Gently place your foot on the cleaner head and recline the handle until you hear a click.

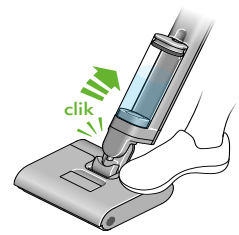
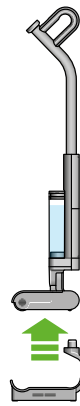

## Selecting cleaning mode

Select the mode using the mode button.



## Starting the machine

Press the power button to start.



## Cleaning method

For maximum pickup, move the machine at a slow pace.

**Tip:** For best results, clean in overlapping passes.

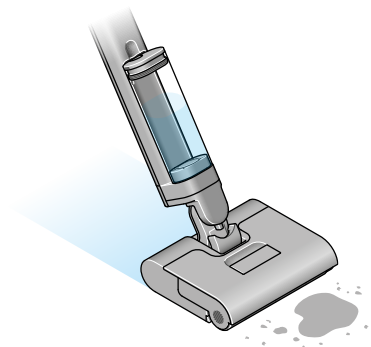

# Self-cleaning and daily maintenance

## Recommended after every clean

Take your Clean+Wash Hygiene to where the waste will be disposed.

### Remove the waste system

Gently lift the waste system from the cleaner head. Once removed, hold the system upright with the debris tray facing upwards, and dirty water tank below.

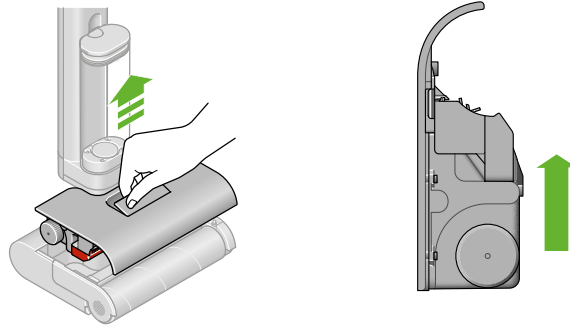

### Dispose of dry debris

Pull the debris tray from the side of the system, and tap any debris into the bin.

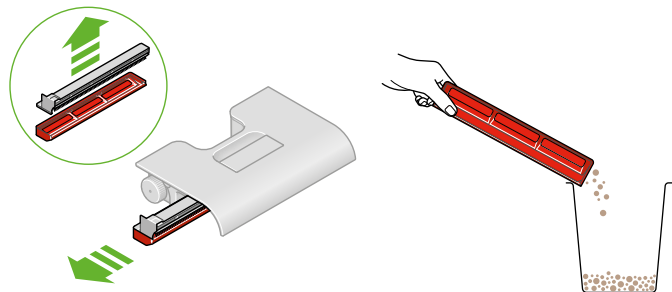

### Clean the debris tray

Rinse the debris tray, anti-tangle comb and sprung mangle with clean running water.

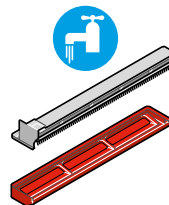

### Empty and clean the dirty water tank

Dispose of dirty water from the dirty water tank and rinse with clean water.

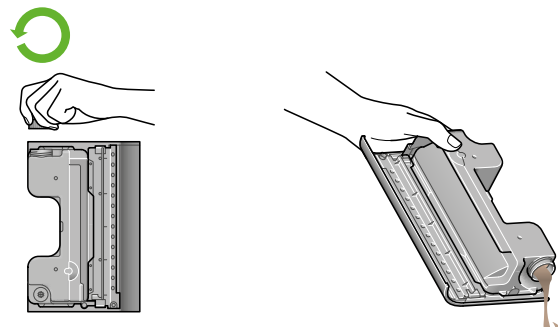

# Self-cleaning and daily maintenance

## Recommended after every clean

### Re-assemble the waste system

Place the debris tray back into the waste system, ensuring it is fitted all the way in.

### Replace the waste system

Slot the whole waste system back into the cleaner head. Ensure that it is fully locked into place by pressing firmly on the central red lever until you hear a loud click. Place the machine on the dock.

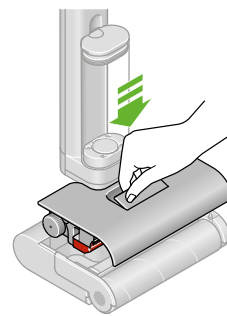
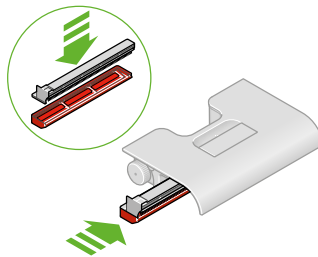

### Setting up for self-clean

Fill the clean water tank to the MAX line or just under if adding solution which should be measured to 20ml.

The LCD menu will auto-prompt 'Self-Clean'. Follow the instructions and press the MAX button to start self-cleaning. If battery is below 30%, the LCD menu will alert 'Low Battery' and self-clean will be disabled until battery is charged to 30%.

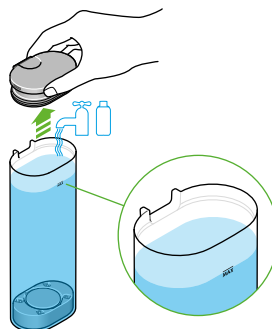

### Hot-air drying

The cleaning cycle runs for 145 seconds, flushing and refreshing the system.

Hot-air drying will automatically start after the self-clean cycle and will run for 30 mins.

After completion, empty the dirty water tank.

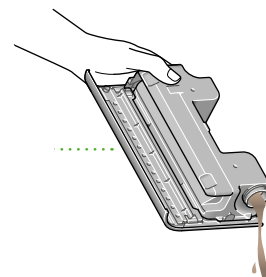
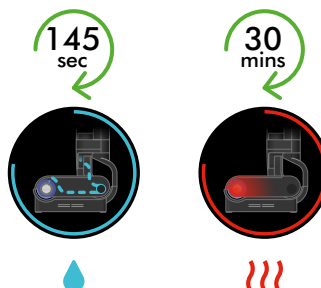

# Regular maintenance

Recommended once every other week

## Remove the roller

Unlock and remove the roller from the side of the cleaner head, detaching it from the motor component.

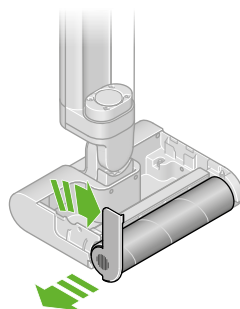

## Wash the roller

Wash the roller in a sink, using warm water and gentle detergent. Squeeze to remove excess water and leave to dry.

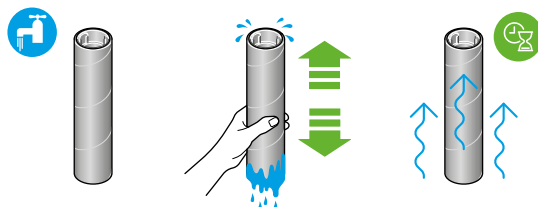

## Clean the end cap and the motor component

Remove any residue, debris or hair on the end cap and the motor component. Use a damp cloth to wipe clean if needed.

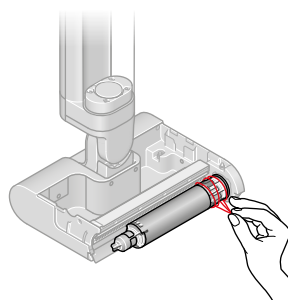

## Clean the squeegee

Check behind the motor component to see if there is any residue left on the squeegee. Use a damp cloth to wipe clean if needed.

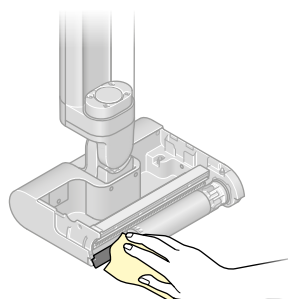

## Reattach the roller

Reattach the roller to the end cap. Slide the roller onto the motor component and lock it from the side.

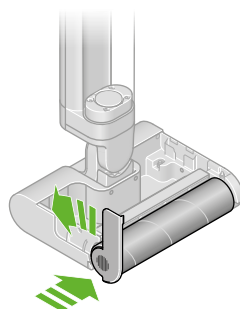

## Cleaning the dock

Remove the machine from the dock. Make sure the charger is disconnected from the mains before cleaning. Wipe the dock with warm water, detergent and a cloth. Allow to dry before reconnecting to the mains.

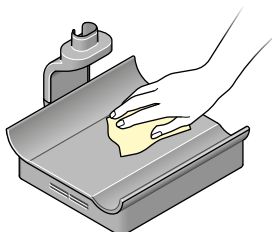

# Deep-clean maintenance

## Recommended every 6 months

### Deep cleaning the debris tray

#### Remove the waste system

Gently lift the waste system from the cleaner head.  
Once removed, hold the system upright with the debris tray facing upwards, and dirty water tank below.

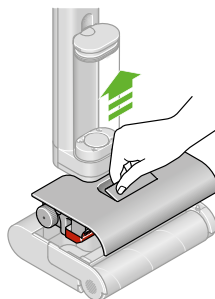

#### Dispose dry debris

Pull the debris tray from the side of the system,  
tap any debris into the bin.

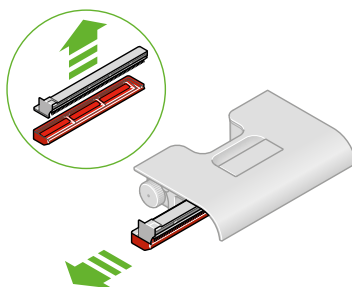

#### Soak the debris tray

Soak in citric acid/vinegar for one hour to remove limescale.

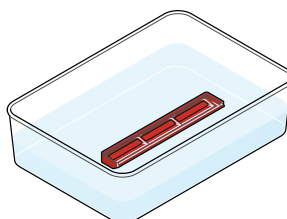

#### Re-assemble the waste system

Place the debris tray back into the waste system, ensuring it  
is fitted all the way in.

#### Replace the waste system

Slot the whole waste system back into the cleaner head.  
Ensure that it is fully locked into place by pressing firmly on  
the central red lever until you hear a loud click. Place the  
machine on the dock.

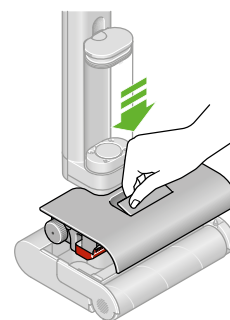
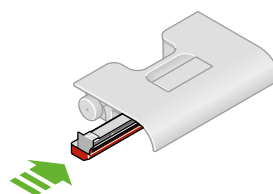

# Deep-clean maintenance

## Recommended every 6 months

### Deep-cleaning the waste tank

#### Remove the waste system

Gently lift the waste system from the cleaner head. Once removed, hold the system upright with the debris tray facing upwards, and dirty water tank below.

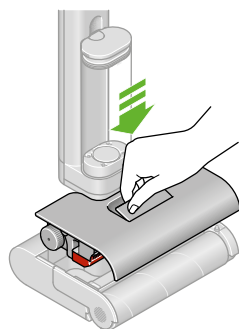

#### Remove the debris tray

Pull the debris tray from the side of the system.

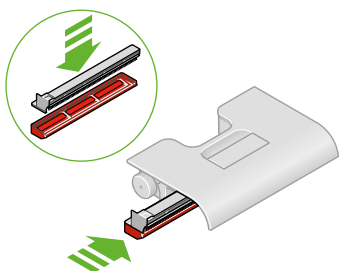

#### Clean the dirty water tank

Rinse the dirty water tank with warm water and detergent. The whole waste tank can be fully submerged in water and formulation for a deeper clean if necessary.

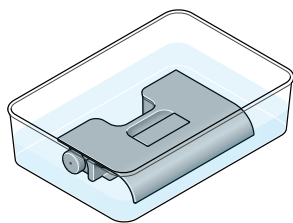
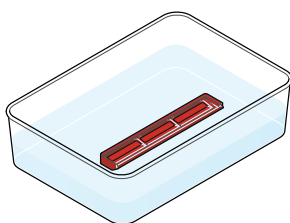

#### Clean the rubber dirty water tank cap

Rotate and remove the rubber cap from the bottom of the dirty water tank.

Wash in a sink using warm water, gentle detergent and a cloth. Run clean water through the gap on the dirty water tank to remove any remaining dirt.

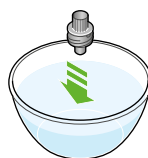
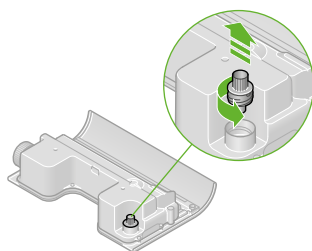

#### Re-assemble the waste system

Place the debris tray back into the waste system, ensuring it is fitted all the way in.

#### Replace the waste system

Slot the whole waste system back into the cleaner head. Ensure that it is fully locked into place by pressing firmly on the central red lever until you hear a loud click. Place the machine on the dock.

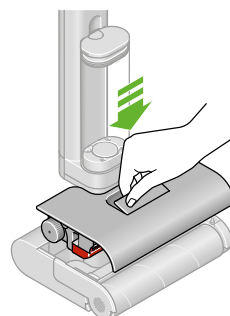
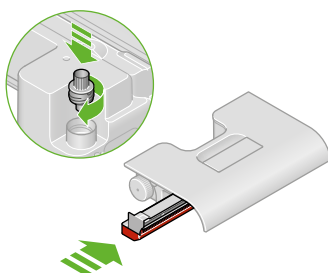

# Deep-clean maintenance

## Recommended every 6 months

### Replace the roller

Your Dyson Clean+Wash Hygiene microfibre roller has a lifespan of 43 hours. We recommend you replace it every 6 months, or when prompted to do so on the LCD screen. A QR code will be displayed for ordering replacements from Dyson.





# Battery and performance tips

Keep your Clean+Wash Hygiene on the dock and store it in a cool environment (<35°C) to best maintain battery health.

Avoid storing the cleaner with a dirty tank, dirty debris tray or dirty roller – always empty and set to self-clean after use.

Use MAX mode for stubborn stains.

Replace parts promptly when alerted.

---

## Disassemble your machine

Should you need to store or repackage your machine, detach the wand from the main body.

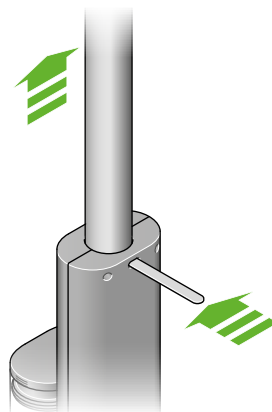

# Troubleshooting

## **Excessive water leaking during usage or self-cleaning**

Ensure that the debris tray has been assembled correctly, and that the waste system is firmly clicked into the cleaner head.

## **No water output**

Check that the clean water tank is full and seated correctly.

## **Poor pickup**

Clean the roller, debris tray, sprung mangle and squeegee.

Replace the roller every 6 months (or sooner, if worn).

Your machine will alert you when they need to be changed.

## **Short run time**

Fully charge the battery before use, avoid excessive use of MAX mode.

## **Dirty Water Tank (DWT) alert**

Empty the DWT and place it back properly, ensuring that it's fully clipped in.

## **Error alert**

Refer to MyDyson™ app for guidance.

---

# Support and service

- Visit [Dyson.co.uk](https://www.dyson.co.uk) for videos, tips, and spare parts ordering.
- Contact Dyson Customer Care for assistance.