

dyson pure cool

User guide
使用者指南

DP04 TP04 TP06

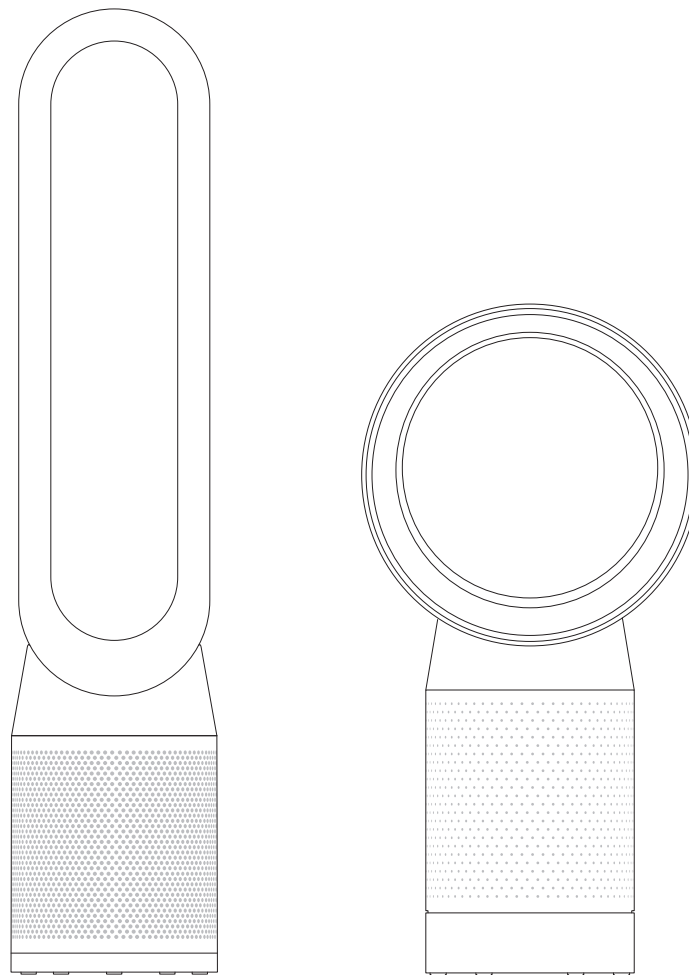

To read your User guide in English go to page 4.
若要閱讀繁體中文版手冊，請翻至第 20 頁。

EN

Contents

Getting started

- 6 Activating your guarantee
- 7 Important safety instructions
- 10 Assembling your machine
- 11 Using your machine
- 11 Power and continuous monitoring
- 12 Information menu
- 14 Auto mode
- 14 Airflow
- 15 Oscillation
- 15 Night mode and Sleep timer
- 16 Looking after your machine
- 16 Additional information

Thank you for choosing to buy
a Dyson purifying fan

Take full control with
the Dyson Link app

Get step-by-step setup and support.

Control how and when your Dyson
purifying fan operates.

Monitor air quality with visual updates.

Automatically keep up to date with the
latest software updates.

Download the Dyson Link app

Download the Dyson Link app from the
App Store or Google Play.
Open the app and follow the on-screen
instructions to create a new account.



For further information and support:
Online

TW: www.dyson.tw/support

HK: www.dyson.hk/support

MY: www.dyson.my/support

SG: www.dyson.com.sg/support

On the phone

TW: 0800 251 209

HK: (852) 2926 2300

MY: +603 7969 1313

SG: 1800-3976674

Apple and the Apple logo are trademarks of Apple
Inc., registered in the U.S. and other countries. App
Store is a service mark of Apple Inc., registered in
the U.S. and other countries.

Google Play and the Google Play logo are
trademarks of Google Inc.

Activating your guarantee

We don't stop caring about our machines once they're yours. After registering your free 2-year guarantee, your Dyson purifying fan will be covered for parts and labour (excluding filters) for two years from the date of purchase, subject to the terms of the guarantee. Even after your guarantee has ended, we'll still be on hand to help.

Free Dyson parts and labour
Hassle-free replacement
Expert advice. 7 days a week.
'How to' videos and helpful tips

Your serial number can be found on your rating plate which is on the base of your machine.

Note your serial number for future reference.



This illustration is for example purposes only.



Three easy ways to activate your free 2-year guarantee



On your mobile
Download the Dyson Link app and you'll be taken through activation as part of the set up.



Online
Visit our website to activate your full parts and labour guarantee online.
TW: www.dyson.tw/support
HK: www.dyson.hk/support
MY: www.dyson.my/support
SG: www.dyson.com.sg/support



By phone
Call our dedicated Helpline.
TW: 0800 251 209
HK: (852) 2926 2300
MY: +603 7969 1313
SG: 1800-3976674

IMPORTANT SAFETY INSTRUCTIONS

BEFORE USING THIS APPLIANCE READ ALL INSTRUCTIONS AND CAUTIONARY MARKINGS IN THIS USER MANUAL AND ON THE APPLIANCE

When using an electrical appliance, basic precautions should always be followed, including the following:

WARNING

THE APPLIANCE AND THE REMOTE CONTROL BOTH CONTAIN MAGNETS.

1. Pacemakers and defibrillators may be affected by strong magnetic fields. If you or someone in your household has a pacemaker or defibrillator, avoid placing the remote control in a pocket or near to the device.
2. Credit cards and electronic storage media may also be affected by magnets and should be kept away from the remote control and the top of the appliance.

WARNING

These warnings apply to the appliance, and also where applicable, to all tools, accessories, chargers or mains adaptors. **TO REDUCE THE RISK OF FIRE, ELECTRIC SHOCK, OR INJURY:**

3. This Dyson appliance is not intended for use by persons (including children) with reduced physical, sensory or mental capabilities, or lack of experience and knowledge, unless they have been given supervision or instruction by a responsible person concerning use of the appliance to ensure that they can use it safely. Cleaning and user maintenance should not be performed by children without supervision.
4. Ensure that the appliance is fully assembled in line with the instructions before use.
5. Do not allow to be used as a toy. Close attention is necessary when used by or near children. Children should be supervised to ensure that they do not play with the appliance.
6. Use only as described in this Dyson User manual. Do not carry out any maintenance other than that shown in this manual, or advised by the Dyson Helpline.

7. Suitable for dry locations ONLY. Do not use outdoors or on wet surfaces and do not expose to water or rain.
8. Do not handle any part of the plug or appliance with wet hands.
9. Do not operate any appliance with a damaged cable or plug. Discard the appliance or return to an authorised service facility for examination and/or repair. If the supply cable is damaged it must be replaced by Dyson, its service agent or a similarly qualified person in order to avoid a hazard.
10. If the appliance is not working as it should, if it has received a sharp blow, if it has been dropped, damaged, left outdoors, or dropped into water, do not use and contact the Dyson Helpline.
11. Do not stretch the cable or place the cable under strain. Keep cable away from heated surfaces.
12. Do not run cable under carpeting. Do not cover cable with throw rugs, runners or similar coverings. Arrange cable away from traffic area and where it will not be tripped over.
13. Do not unplug by pulling on the cable. To unplug, grasp the plug, not the cable. The use of an extension cable is not recommended.
14. Do not put any objects into openings or the air inlet holes. Do not use with any openings blocked; keep free of dust, lint, hair, and anything that may reduce airflow.
15. Do not use any cleaning agents or lubricants on this appliance. Unplug before cleaning or carrying out any maintenance, and before replacing the filter.
16. Always carry the appliance by the base, do not carry it by the loop amplifier.
17. Turn off all controls before unplugging. Unplug from socket when not in use for extended periods. To avoid a tripping hazard, safely coil the cable.
18. Do not use near furnaces, fireplaces, stoves or other high temperature heat sources.
19. Do not use in conjunction with or directly next to an air freshener or similar products. Do not spray or apply perfumes directly on or near the filter. Keep essential oils and chemicals away from the appliance.
20. Chemical Burn and Choking Hazard. Keep batteries away from children. This appliance contains a lithium button/coin cell battery. If a new or used lithium button/coin cell battery is swallowed or enters the body, it can cause severe internal burns and can lead to

death in as little as 2 hours. Always completely secure the battery compartment. If the battery compartment does not close securely, stop using the appliance, remove the batteries, and keep it away from children. If you think batteries might have been swallowed or placed inside any part of the body, seek immediate medical attention.

21. When removing or replacing the filter, take care to keep your fingers clear.
22. This appliance must only be supplied at safety extra low voltage corresponding to the marking on the base. Dyson recommends that this appliance is only to be used with the power supply unit provided with it.

READ AND SAVE THESE INSTRUCTIONS

**THIS DYSON APPLIANCE IS INTENDED FOR
HOUSEHOLD USE ONLY.**

Assembling your machine

Dyson Pure Cool™ purifying fan
Supplied with separate carbon and glass HEPA filters.

Remove the shrouds and filters from any protective packaging.

Push the carbon filters into place on the machine.

Put the shrouds, with the HEPA filters in place, into position on the base and push firmly until they both click securely into place.

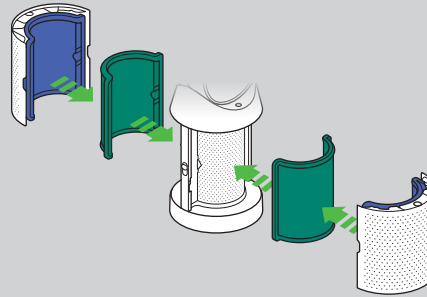

Use both hands to lift your Dyson purifying fan out of the box, by its base.

Don't lift it out by the amplifier loop.

Dyson Pure Cool™ purifying fan with Dyson Cryptomic™ technology
Supplied with combination and formaldehyde filters.

Your Dyson purifying fan comes fitted with a permanent formaldehyde filter.

Remove the shrouds from any protective packaging.

Put the shrouds, with the filters in place, into position on the base and push firmly until they both click securely into place.

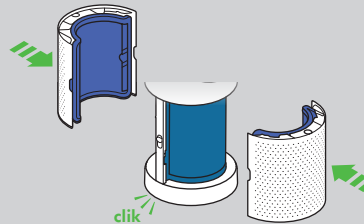

Place the remote control on top of the machine with the buttons facing down.

Plug in and switch on.

Using your machine

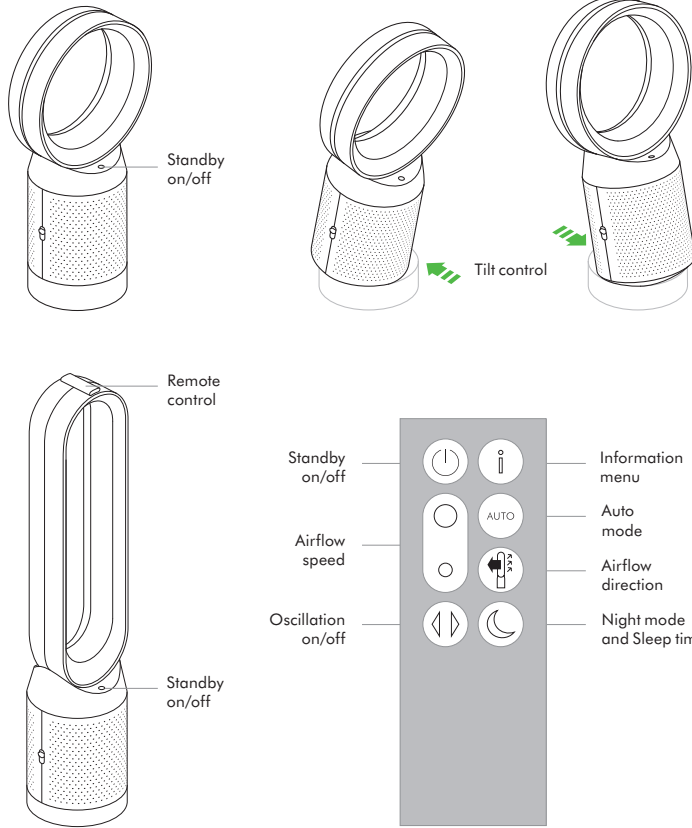

Power and continuous monitoring

Standby on/off

Press the Standby on/off button on your Dyson purifying fan or remote control to stop your machine. It will continue to monitor the air quality.

Continuous monitoring

With continuous monitoring turned on, your Dyson purifying fan will gather air quality, temperature and humidity information, which is displayed on the LCD screen and in the Dyson Link app.

Continuous monitoring is turned off by default. Once turned on, it will always be active until you turn it off again.

Continuous monitoring on/off

Press and hold the Auto mode button on the remote control for five seconds to turn it on. The LCD screen will indicate when continuous monitoring is on or off.

Wi-Fi connectivity

Wi-Fi is on by default. To turn the Wi-Fi on or off, press and hold the Standby on/off button on your machine for five seconds.

Information menu

Press this button to scroll through the information being monitored by your Dyson purifying fan.

Information about air quality, temperature, humidity and filter levels is shown on the LCD screen.

When a particular type of pollutant causes air quality to decrease, a symbol for the pollutant will show on the LCD Screen.

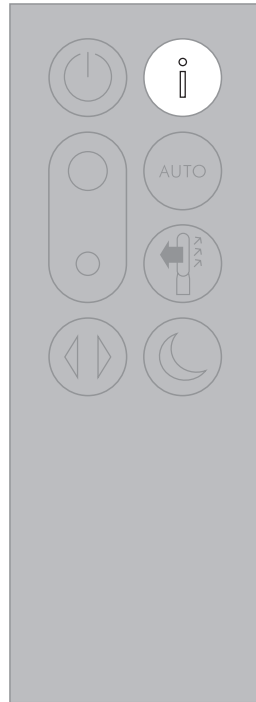

Indoor air quality - 12 seconds
Monitor the current air quality with a graph showing the last 12 seconds of data.

 **15°C**

Indoor temperature
Monitor the ambient temperature to help maintain a comfortable environment.



Particulate matter (PM2.5)
Monitors the presence of microscopic particles up to 2.5 microns in size, suspended in the air we breathe. These include smoke, bacteria and allergens.



Particulate matter (PM10)
Monitors the presence of larger microscopic particles, up to 10 microns in size, suspended in the air we breathe. These include dust, mould and pollen.



Volatile organic compounds
VOC's are typically odours that may be potentially harmful. These can be found in cleaning products, paints and new furnishings.



Nitrogen dioxide and other oxidising gases
These potentially harmful gases are released into the air by combustion, for example the burning gas when cooking and in vehicle exhaust emissions.

 **73%**

Indoor humidity
Displays the amount of water vapour in the air, shown as a percentage of the maximum possible humidity at the current temperature.



Filters
The remaining filter life is shown on the LCD screen and will indicate when your filters need replacing.



Wi-Fi
Displays the current status of the connection to the Wi-Fi network.

Auto mode

Set your Dyson purifying fan to Auto mode and the on-board sensors will intelligently adjust the settings of the machine according to the air quality.

Air quality: Your machine will pause when the target air quality has been reached, switching on again when the air quality levels drop.

Airflow speed: The airflow speed will increase until the target air quality and temperature have been reached.

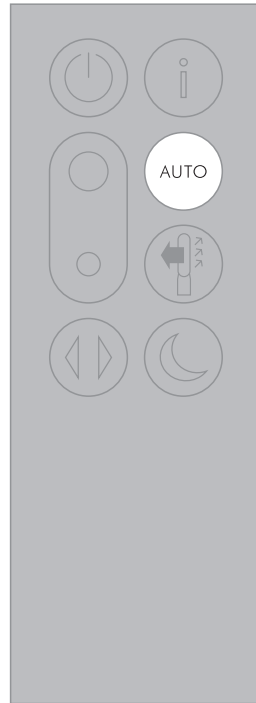

Airflow

Press the Airflow speed button to increase and decrease the airflow speed.

Press the Airflow direction button to change the direction of airflow from front to back. Your machine will continue to purify in both settings.

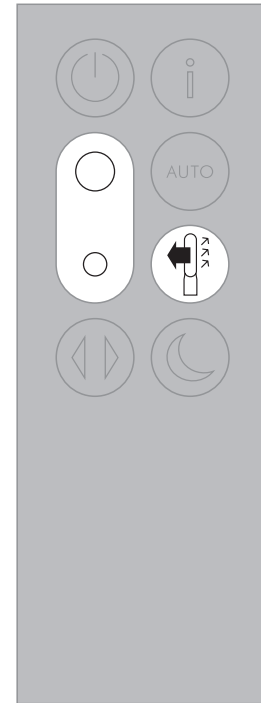

Oscillation

Press the Oscillation button to circulate the air around the room and scroll through the settings from 0° to 350°.

Customise your oscillation settings in the Dyson Link app.

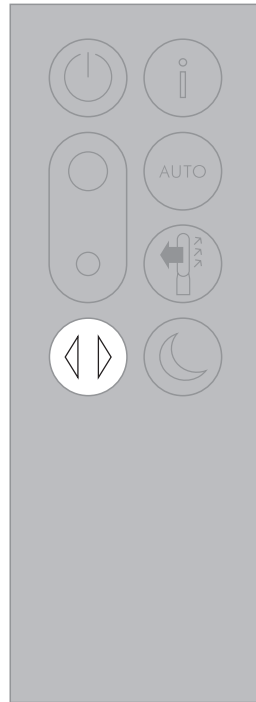

Night mode and Sleep timer

In Night mode, your Dyson purifying fan will continue to monitor and respond to changes in air quality, but only using its quietest settings – and with its LCD screen dimmed.

Press the Night mode and Sleep timer button to scroll through the timer options.

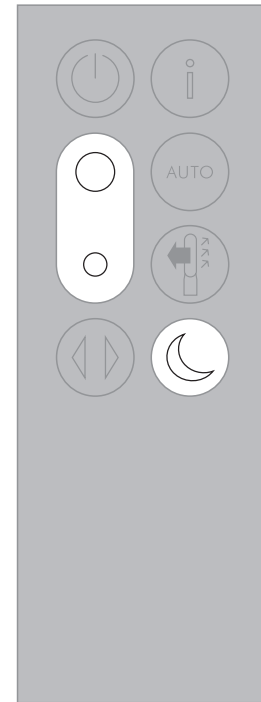

Looking after your machine

To always get the best performance from your Dyson purifying fan, it's important to regularly clean it and check for blockages.

Cleaning

If dust accumulates on the surface of your machine, wipe dust from the loop amplifier, filter unit and other parts with a dry or damp cloth.

Look for blockages in the air inlet holes on the filter and the small aperture inside the loop amplifier.

Use a soft brush to remove dust and debris.

Don't use detergents or polishes to clean your machine.

Changing your filters

The Dyson Link app and LCD screen on your machine will indicate when to change your filters.

Order new filters on the Dyson Link app or www.dyson.com. Your new

filters will come with instructions, go online for further support and videos.

Don't use your Dyson purifying fan without the filters in place. Unplug your machine from the mains electricity supply before cleaning or changing filters.

Error codes

If your machine shows an error code, try turning it off and then on again. If this doesn't clear the error code contact Dyson Customer Care.

For further information and support about the care and maintenance of your machine and replacing the filters go to the Dyson Link app or online:

TW: www.dyson.tw/support

HK: www.dyson.hk/support

MY: www.dyson.my/support

SG: www.dyson.com.sg/support

Additional information

CONTROL WITHOUT REMOTE

- The machine can be controlled through your Dyson Link app.

DYSON LINK APP CONNECTIVITY

- You must have a live internet connection in order for the Dyson Link app to work.
- The machine can connect to either 2.4GHz or 5GHz networks which includes most modern routers. Check your router documentation for compatibility.
- The Dyson Link app requires an iOS device with at least iOS version 10* or an Android device with at least Android version 5.
- Your mobile device must have Bluetooth® wireless technology 4.0 support (Bluetooth® wireless technology Low Energy) in order to set up a connection with the appliance. Check your device specification for compatibility. The Bluetooth® word mark and logos are registered trade marks owned by the Bluetooth SIG, Inc. and any use of such marks by Dyson is under license. Supported Wi-Fi protocols:
 - IEEE802.11a
 - IEEE802.11b (Not recommended)
 - IEEE802.11g
 - IEEE802.11n

REPLACEABLE PARTS

BATTERY REPLACEMENT

CAUTION

- Unscrew the battery compartment on the remote control. Loosen the base and pull to remove the battery.
- Do not install backwards or short-circuit the batteries.
- Do not attempt to dismantle or charge the batteries. Keep away from fire.
- Follow the battery manufacturers' instructions when installing new batteries (battery type CR 2032).
- Always replace the screw in the remote control and refer to the battery hazard in the warning section.

NON-WASHABLE FILTER UNITS

- Your filter units are non-washable and non-recyclable.
- To replace your filter units follow the steps as shown.
- Failure to replace the filter units when prompted may result in changes to product performance and appearance.
- New filter units can be purchased at www.dyson.com/support

AUTO MODE

- A period of 6 days is required after the machine is first used for the sensor to calibrate. During this period the machine may be more sensitive to VOCs (such as odours) than normal.

DISPOSAL INFORMATION

- Dyson products are made from high-grade recyclable materials. Recycle where possible.
- Dispose of or recycle the battery in accordance with local ordinances or regulations.
- Keep the used batteries away from children as these can still harm children if swallowed.
- Your filter units are non-washable and non-recyclable.
- Dispose of the exhausted filter units in accordance with local ordinances or regulations.
- The battery should be removed from the product before it is discarded. When removing the battery, the machine must be powered off. The battery should be safely disposed of.

DYSON CUSTOMER CARE

THANK YOU FOR CHOOSING TO BUY A DYSON MACHINE

After registering your 2 year guarantee, your Dyson machine will be covered for parts (excluding filters) and labour for 2 years from the date of purchase, subject to the terms of the guarantee. However, indispensable legal rights of the final consumer under applicable national legislation governing the sale of consumer goods are not affected by the terms of the guarantee. If you have any queries regarding your Dyson machine, visit www.dyson.com/support for online help, general tips and useful information about Dyson.

Alternatively, you can call the Dyson Helpline with your serial number and details of where and when you bought the machine.

Your serial number can be found on your rating plate which is on the base of your machine.

If your Dyson machine needs a service, call the Dyson Helpline so we can discuss the available options. If your Dyson machine is under guarantee, and the repair is covered, it will be repaired at no cost.

PLEASE REGISTER AS A DYSON MACHINE OWNER

To help us ensure that you receive prompt and efficient service, please register as a Dyson machine owner. There are three ways to do this:

- By email:
HK: pidcs@jebesen.com
MY: dysoncs@dancom.com.my
TW: service@hlh.com.tw
SG: sg.service@dyson.com
- By calling the Dyson Helpline.
- Smartphone: Download the Dyson Link app and you will be taken through registration as part of the set up.
This will confirm ownership of your Dyson machine in the event of an insurance loss, and enable us to contact you if necessary.

LIMITED 2 YEAR GUARANTEE

TERMS AND CONDITIONS OF THE DYSON 2 YEAR LIMITED GUARANTEE

WHAT IS COVERED

- The repair or replacement of your Dyson machine (at Dyson's discretion) if it is found to be defective due to faulty materials, workmanship or function within 2 years of purchase or delivery (if any part is no longer available or out of manufacture, Dyson will replace it with a functional replacement part).
- This guarantee will only be valid if the machine is used in the country in which it was sold.

WHAT IS NOT COVERED

- Replacement filter units. The machine's filter units are not covered by the guarantee. Dyson does not guarantee the repair or replacement of a machine where a defect is the result of:
- Damage caused by not carrying out the recommended machine maintenance.
- Accidental damage, faults caused by negligent use or care, misuse, neglect, careless operation or handling of the machine which is not in accordance with the Dyson User guide.
- Use of the machine for anything other than normal domestic household purposes.
- Use of parts not assembled or installed in accordance with the instructions of Dyson.
- Use of parts and accessories which are not genuine Dyson components.
- Faulty installation (except where installed by Dyson).
- Repairs or alterations carried out by parties other than Dyson or its authorised agents.
- Blockages – Please refer to the 'Looking after your machine' section and illustrations in this Dyson User guide for details of how to look for and clear blockages.
- Normal wear and tear (e.g. fuse etc.).
- Reduction in battery discharge time due to battery age or use (where applicable).
If you are in any doubt as to what is covered by your guarantee, please contact Dyson.

SUMMARY OF COVER

- The repair or replacement of your Dyson machine under guarantee will not extend the period of guarantee.
- The guarantee provides benefits which are additional to and do not affect your statutory rights as a consumer.
- The guarantee becomes effective from the date of purchase (or the date of delivery if this is later).
- You must provide proof of (both the original and any subsequent) purchase/delivery before any work can be carried out on your Dyson machine. Without this proof, any work carried out will be chargeable. Keep your receipt or delivery note.
- All work will be carried out by Dyson or its authorised agents.
- Any parts which are replaced by Dyson will become the property of Dyson.

IMPORTANT DATA PROTECTION INFORMATION

You will need to provide us with basic contact information when you register your Dyson machine or the Dyson Link app;

WHEN REGISTERING YOUR DYSON MACHINE:

- You will need to provide us with basic contact information to register your machine and enable us to support your guarantee.

WHEN REGISTERING VIA THE DYSON LINK APP

You will need to provide us with basic contact information to register the Dyson Link app; this enables us to securely link your machine to your instance of the app.

- When you register, you will have the opportunity to choose whether you would like to receive communications from us. If you opt-in to communications from Dyson, we will send you details of special offers and news of our latest innovations.
- We never sell your information to third parties and only use information that you share with us as defined by our privacy policies which are available on our website at [privacy.dyson.com](https://www.dyson.com/privacy)

TW/HK

目錄

快速入門

- 22 啟用您的保固
- 23 重要安全注意事項
- 26 組裝您的機器
- 27 使用您的機器
- 27 電源和持續監測
- 28 資訊功能表
- 30 自動模式
- 30 氣流
- 31 擺動
- 31 夜間模式和睡眠計時器
- 32 照顧您的機器
- 32 其他資訊

感謝您選購戴森空氣清新機

藉由 Dyson Link 應用程式可全盤掌控

取得逐步的設定與支援。
控制戴森淨化風扇的操作方式和時間。
通過視覺更新監測空氣品質。
會自動隨時保持最新軟體更新。

下載 Dyson Link 應用程式

從 App store 或是 Google Play 下載 Dyson Link 應用程式。
開啟應用程式並依照螢幕上的指示建立新的帳戶。



如需更多資訊和支援：
線上：

TW: www.dyson.tw/support

HK: www.dyson.hk/support

MY: www.dyson.my/support

SG: www.dyson.com.sg/support

從手機：

TW: 0800 251 209

HK: (852) 2926 2300

MY: +603 7969 1313

SG: 1800-3976674

Apple 和 Apple 標誌是 Apple Inc. 在美國和其他國家或地區註冊的商標。App Store 是 Apple Inc. 在美國和其他國家或地區註冊的服務標誌。Google Play 和 Google Play 標誌均為 Google Inc. 的商標。

啟用您的保固

您擁有我們的機器後，我們並未停止關心。
在完成 2 年的免費保固註冊之後，您的戴森淨化風扇享有自購買日起兩年的零件和維修服務保固（濾網除外），但必須遵守保固條款的規定。
即使您的保固期已過，我們仍竭誠為您服務。

在您的標牌上可以找到序號，標牌位於產品的底部。

請記下您的序號以備日後參考。



本說明僅供示範之用。



免費戴森零件和維修服務
免繁雜的更換服務
專家級的建議。每週 7 天。
「用法介紹」影片和實用祕訣

三種啟用 2 年免保固的方法



在您的手機上
下載 Dyson Link 應用程式，然後在
安裝過程中根據提示完成註冊。



線上：
請造訪我們的網站，線上註冊以充
分享有您的零件維修人工保固。
TW: www.dyson.tw
HK: www.dyson.hk
MY: www.dyson.my
SG: www.dyson.com.sg



通過電話
致電我們的服務專線。
TW: 0800 251 209
HK: (852) 2926 2300
MY: +603 7969 1313
SG: 1800-3976674

重要安全說明

使用本產品前，請先閱讀本手冊和本產品上的所有指示及警告提示。

使用電器時應確實遵守基本預防措施，包括下列各項：

警告

產品以及遙控器中都含有磁鐵。

1. 心臟節律器及除顫器可能受到強磁場影響。如您或您的家人安有心臟節律器或除顫器，請勿將遙控器放在口袋或接近心臟節律器或除顫器的地方。
2. 信用卡以及電子儲存媒體可能會受到磁鐵的影響，因此應避免放置在遙控器和產品頂端附近。

警告

這些警告適用於本產品、所有工具與附件，以及需要用到的任何充電器或電源配接器。

為了降低起火燃燒、電擊或受傷的危險：

3. 本戴森產品不適合行動不便、知覺或心理障礙的人士使用，亦不適合缺乏使用經驗或一定程度認識者（包含孩童），除非在專人指導或監督，確保安全無虞的情況下方能使用。兒童在無人監督的情況下，不得進行清潔與使用者維護的工作。

4. 在使用本產品前，請確定已經按照說明完成組裝。
5. 切勿將本產品當做玩具使用。由兒童使用或接近兒童時，尤須密切注意。應注意不要讓兒童亂玩產品。
6. 只能依照《戴森使用者手冊》中所述來使用。請勿執行非本手冊所載明或是非戴森服務專線所建議的維護。
7. 本產品僅適合在乾燥環境下使用。本產品不得在戶外或潮濕地面使用，切勿水浸雨淋。
8. 請勿以濕手觸摸插頭或產品的任何部分。
9. 纜線或插頭損壞時，請勿操作任何設備。將設備丟棄或是送交授權的維修經銷商進行檢查和/或修理。如果電源線損壞，必須交由戴森、戴森維修代理或類似的合格人員更換以免發生危險。
10. 如果產品運作不正常、受到嚴重撞擊、掉落、損壞、遺忘於室外或掉入水中，請勿使用並聯絡戴森服務專線。
11. 不可拉扯重壓電線。電線請遠離高溫表面。
12. 請勿將電線鋪設在地毯下。請勿將腳踏墊、小地毯或類似物品覆蓋電線。請將電線遠離走動區域和容易被絆倒的地方。
13. 拔插頭時請勿拉扯電線。拔除插頭時，請緊抓住插頭，而非電線。不建議使用電源延長線。
14. 請勿將異物放入進出風口。在任何進出風口堵塞的狀況下請勿使用；請排除任何灰塵、棉絮、毛髮或任何會阻礙氣流的物體。

15. 請勿對本產品使用任何清潔劑或潤滑劑。在進行清潔或任何保養之前，請將插頭拔下。
16. 搬運本產品時請始終持握產品的底部，不要以拿住橢圓形出風框的方式搬運。
17. 拔插頭前請關閉所有裝置。如長時間不使用本產品，請將插頭從插座中拔出。為避免使人絆倒，請將電線妥善纏繞收起。
18. 使用本產品時請遠離火爐、壁爐、爐灶或其他高溫熱源。
19. 請勿將它與空氣清香劑或是類似產品一起使用，或是直接在其旁邊使用。請勿在濾網上或附近噴灑或塗覆香料。將精油和化學品遠離本產品放置。
20. 化學灼傷危險。請將電池放置在兒童拿不到的地方。本產品包含鈕扣型/硬幣型鋰電池。如果新的或用過的鈕扣型/硬幣型鋰電池被誤吞或是進入身體，可能會造成嚴重的內部灼傷，並且可能最少在 2 小時內導致死亡。請確保電池盒蓋完全安全。如果未安全地關閉電池盒蓋，請停止使用本產品、移除電池，並且將它放置在兒童拿不到的地方。如果認為電池已被誤吞或是已放入身體的任何部位，請立即尋求醫療協助。
21. 取出或更換濾網時，請注意不要碰到手指。
22. 本產品只能使用底座標示的安全極低電壓來供電。戴森建議本產品僅使用它所隨附的電源供應裝置。

請仔細閱讀並妥善保管說明手冊

本戴森產品僅供居家使用。

組裝您的機器

Dyson Pure Cool™ purifying fan
提供單獨的碳和玻璃
HEPA 濾網。

自任何保護性包裝中取出護罩和
濾網。

將碳濾清器推入機器上。

將已裝妥 HEPA 濾網的護罩放入
底座並壓緊，直到兩者穩固卡合。

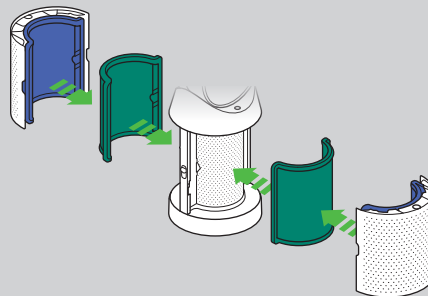

用雙手持握底部把您的戴森
淨化風扇從盒子裡抬出。

請勿以握住橢圓形出風框的
方式取出。

**Dyson Pure Cool™ purifying
fan with Dyson Cryptomic™
technology**
提供組合和甲醛濾網。

您的戴森淨化風扇隨附安裝有甲
醛濾網，不應將其拆除。

取下任何保護性包裝上護罩。

將已穩妥安裝濾網的護罩放入底
座並壓緊，直到兩者安全卡合。

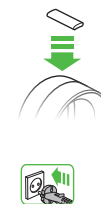
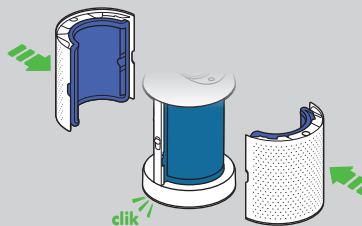

將遙控器置於本產品的頂
端，按鈕面朝下。

插電並開啟。

使用您的機器

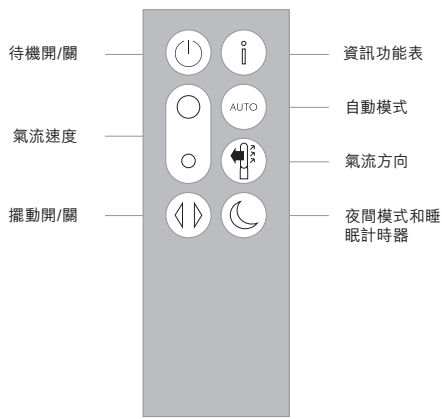
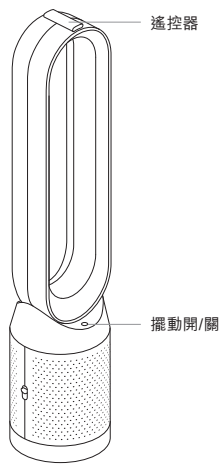
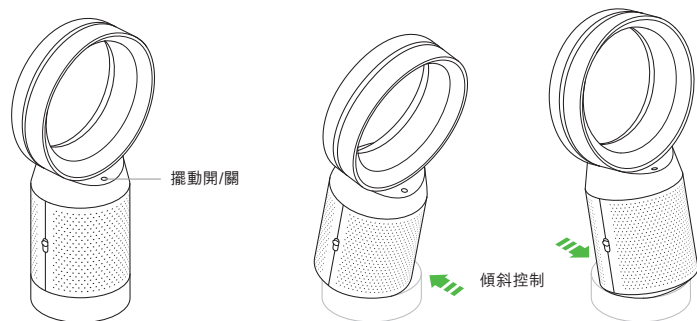

電源和持續監測

待機開/關

按下戴森淨化風扇或遙控器上的待機開啟/關閉按鈕以停止您的機器。它會繼續監測空氣品質。

持續監測

在持續監測功能開啟的情況下，您的戴森淨化風扇會蒐集空氣品質、溫度及濕度資訊，這些訊息將在 LCD 螢幕和戴森連結應用程式中顯示。

持續監測預設處於關閉狀態。一旦打開，它將始終處於活動狀態，直到您再次將其關閉。

持續監測開啟/關閉

按住遙控器上的自動模式按鈕五秒鐘，即可將其開啟。LCD 螢幕將顯示持續監測開啟或關閉的時間。

無線網路連接

Wi-Fi 預設處於開啟狀態。要開啟或關閉 Wi-Fi，請按住機器上的待機開啟/關閉按鈕五秒鐘。

資訊功能表

按此按鈕，捲動檢視戴森淨化風扇監測的資訊。

LCD 螢幕會顯示關於空氣品質、溫度及濕度和過濾程度的資訊。

若特定類型的污染物造成空氣品質降低，則該污染物的符號將會顯示在 LCD 螢幕中。

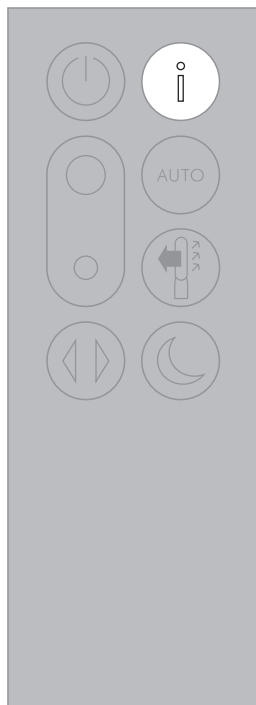

室內空氣品質 - 12 秒
以圖表顯示最近 12 秒的資料，藉此
監控目前的空氣品質。

 15°C

室內溫度
監控環境溫度以協助維持舒適的
環境。



懸浮微粒 (PM2.5)

能監測我們呼吸時懸浮於空氣中的最大 2.5 微米的微粒。這些微粒包括煙霧、細菌和過敏原。



懸浮微粒 (PM10)

能監測在我們呼吸時懸浮於空氣中的最大 10 微米的較大微粒。這些微粒包括灰塵、黴菌和花粉。



揮發性有機化合物

VOC 是可能有害的典型有味化合物。這些化合物存在於清潔產品、油漆和新的傢俱中。



二氧化氮和其他氧化氣體

這些潛在的有害氣體會透過燃燒釋放於空氣中，例如烹煮和車輛廢氣排放時的燃燒氣體。

73%

室內濕度

可顯示空氣中的水汽含量，以目前溫度的最大可能溼度百分比顯示。

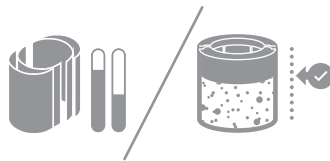

濾網

濾網剩餘的使用壽命顯示在 LCD 螢幕中，並將指示需要更換濾網的時間。



Wi-Fi

可顯示目前連線至 Wi-Fi 網路的狀態。

自動模式

將戴森淨化風扇設定為自動模式時，內建感應器將會智慧地根據空氣品質調整機器的設定。

空氣品質：達到空氣品質目標時，本產品會暫停，並於空氣品質水準下降時再度開啟。

氣流速度：氣流速度會增加，至達到空氣品質及溫度的目標為止。

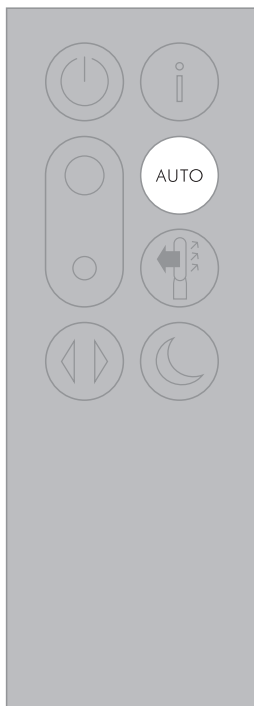

氣流

按下氣流速度按鈕以增加和減少氣流速度。

將會持續淨化空氣，無論是設定空氣從前面或後面流動。使用氣流方向按鈕，兩個選項擇一選取。

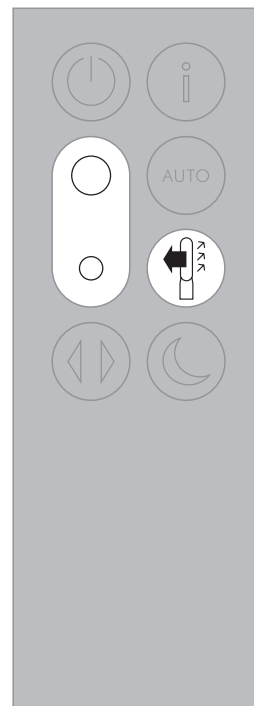

擺動

按此按鈕可使室內空氣循環，並捲動顯示自 0° 至 350° 的擺動設定。

請用 Dyson Link 應用程式為產品設定自訂中心位置與角度。

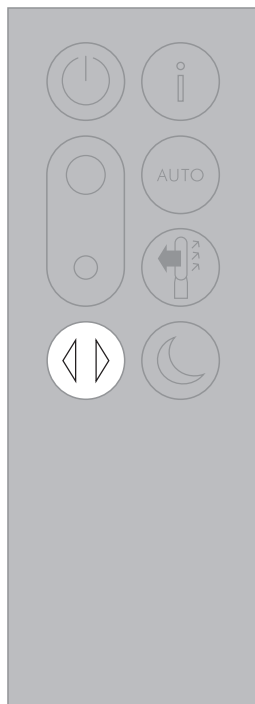

夜間模式和睡眠計時器

夜晚模式下，戴森淨化風扇會持續監測並因應空氣品質的變化，但只會用最安靜的設定 — LCD 螢幕也會調暗。

按下夜間模式和睡眠計時器按鈕，可捲動瀏覽計時器選項。

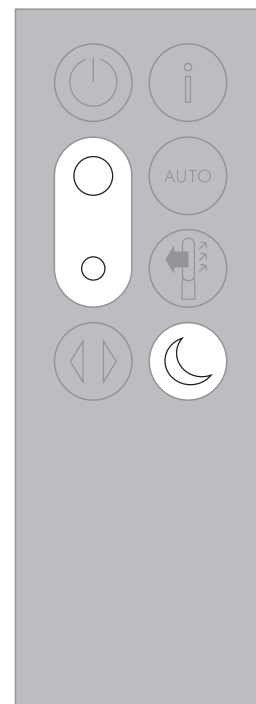

照顧您的機器

為讓戴森淨化風扇始終發揮最佳效能，定期清潔和檢查阻塞情況十分重要。

清潔

如果機器表面堆積灰塵，請使用乾布或溼布將橢圓形出風框、濾網裝置及其他零件擦拭乾淨。

檢查濾網上的入氣孔與橢圓形出風框、內部的小隙縫中是否有阻塞。

使用軟刷來去除灰塵和碎屑。

勿使用清潔劑或亮光劑來清潔您的機器。

更換濾網

您機器上的戴森連結應用程式和 LCD 螢幕將指示何時更換濾網。

請至 Dyson Link 應用程式或 www.dyson.com 訂購新濾網。送到的新濾網會隨附指示說明，可上網尋求進一步支援和觀看影片。

請勿在沒有安裝濾網的情況下使用您的戴森淨化風扇。請先從電源供應管線拔出機器插頭，再進行清潔或更換濾網。

錯誤代碼

若機器顯示錯誤代碼，請先嘗試關閉產品，然後再次開啟。如果這樣無法清除錯誤代碼，請聯絡戴森客戶支援。

關於產品保養與維護以及更換濾網如需進一步資訊和支援，請至 Dyson Link 應用程式或

線上：

(TW) www.dyson.tw/support

(HK) www.dyson.hk/support

(MY) www.dyson.my/support

(SG) www.dyson.com.sg/support

其他資訊

不用遙控器時的控制

- 您可以透過 Dyson Link 應用程式來控制本產品。

DYSON LINK 應用程式連線

- 您必須擁有有效的網際網路連線，才能讓 Dyson Link 應用程式運作。
 - 本產品可連線至 2.4GHz 或 5GHz 網路，包括最現代的路由器。請參閱路由器說明文件，以瞭解其相容性。
 - Dyson Link 應用程式需要具有最新 iOS 版本 10* 的 iOS 裝置或具有最新 Android 版本 5 的 Android 裝置。
 - 您的行動裝置必須具有藍芽 4.0 支援（藍芽低功耗），才能設定與產品之間的連線。查看裝置規格，以瞭解其相容性。
- Bluetooth 字樣和標誌是 Bluetooth SIG, Inc. 擁有的註冊商標，戴森一律於取得授權之下使用此等標記。
- 支援的 Wi-Fi 協議：
 - IEEE802.11a
 - IEEE802.11b (不建議)
 - IEEE802.11g
 - IEEE802.11n

可替換零件

電池更換

注意事項

- 將遙控器上的電池盒旋開。鬆開底部然後將電池拉出取下。
- 請勿反向安裝電池，否則有可能造成電池短路。
- 請勿嘗試拆除電池或對其充電。將電池遠離火源。
- 安裝新電池（電池型號 CR 2032）時，請遵照電池製造商的說明。
- 請務必裝回遙控器中的螺絲，並且瞭解警告區域的電池風險資訊。

不可清洗的濾網裝置

- 您的濾網裝置不可清洗並且不可回收。
- 若要更換濾網裝置，請遵照所示的步驟操作。
- 若未能根據提示及時更換濾網裝置，則可能導致產品效能和外觀發生變化。
- 新濾網裝置可從 www.dyson.tw/support / www.dyson.hk/support 購買。

自動模式

- 本產品在初次使用後需要經過 6 天，感應器才會校準。在此期間，本產品可能對 VOC（揮發性有機化合物，例如異味）感應器比正常情況更為敏感。

棄置資訊

- 戴森產品是由高級的可回收材料所製造。請儘可能回收使用。
- 請依照當地的法規或條例棄置或回收電池。
- 請將廢舊電池放置在兒童拿不到的地方，因為誤吞後仍會對兒童造成危險。
- 您的濾網裝置不可清洗並且不可回收。
- 請按照當地法令或規定丟棄壽命耗盡的濾網裝置。
- 在棄置本產品前，應先將電池取出。

戴森客戶服務

感謝您選購戴森產品。

在完成 2 年保固的註冊之後，您的戴森產品享有自購買日起 2 年的零件（濾網除外）和人工保固，但需遵守保固條款的規定。但是，最終消費者依據有關產品銷售所適用的國家法規享有不可撤銷的合法權利，此類權利不受保固條款規定的影響。

請瀏覽 www.dyson.tw/www.dyson.hk 以獲得有關戴森產品的線上說明、一般提示和其他有用的資訊。

或者，也可以撥打戴森服務專線，並提供您的產品序號及購買地點與時間等資訊。

在您的標牌上可以找到序號，標牌位於產品的底部。

如果您的產品要維修，請撥打戴森客戶服務專線，與我們的服務人員討論可行的方案。若您的產品仍在保固期內，且維修項目在保固範圍內，則不收取任何維修費用。

請登記為戴森產品擁有者

為協助我們確保您能夠獲得立即而且有效的服務，請登記為戴森產品擁有者。

- 透過電子郵件註冊
HK:pidcs@jebesen.com
MY:dysoncs@dancom.com.my
TW:service@hlh.com.tw
SG:sg.service@dyson.com
- 致電戴森客戶服務專線。
- 用智慧型手機註冊。下載 Dyson Link 應用程式，然後在安裝過程中根據提示完成註冊。倘若發生保險損失的情況，如此將可確認您戴森裝置的所有權，並且讓我們在必要時能夠和您聯絡。

2 年保固

戴森 2 年有限保固的條款和條件

保固範圍

- 如果您的戴森產品在購買或交貨之後的 2 年內期間發現因故障材料、製作工藝或功能而出現瑕疵，將由戴森決定提供戴森產品的修理或更換服務（如果有任何零件缺貨或停止生產，戴森可將零件更換為功能性的替代零件）。
- 本產品在銷售國家/地區使用的情况下，本保固方可生效。

不保固範圍

- 替換濾網裝置。本產品的濾網裝置不屬於保固範圍。
- 因下列情況造成的產品需維修或更換不在戴森保固範圍內：
 - 因不進行建議的產品維護而導致的損壞。
 - 使用或保養疏忽、濫用、操作粗心或是處理戴森產品時未能遵照戴森操作手冊造成的意外損壞和故障。
 - 將產品用於任何正常居家使用以外的目的。
 - 未依照戴森說明手冊，組裝或安裝零件。
 - 使用非戴森原廠的零件與配件。
 - 錯誤安裝（戴森安裝的除外）。
 - 非戴森或其授權代理所執行的維修或改動。
- 阻塞 — 請參考本戴森操作手冊中的「問題解決」一節與圖示，瞭解如何檢查與清除阻塞的詳細資訊。
- 正常磨損和損耗（例如保險絲等）。
- 由於電池壽命或電池使用而使得電池放電時間減少。
- 如果您對產品保固範圍有任何疑問，請撥打戴森服務專線。

保固範圍概要

- 維修或更換仍在保固期間的戴森產品並不會延長保固的期間。
- 保固權益是戴森額外提供給您的權益，不影響您的法定消費者權利。
- 保固將於購買日開始生效（若送貨日期較晚則以收到貨該日為準）。
- 在您的戴森產品進行任何處理之前，您必須提供（正本及影本均可）交貨/購買的證明。沒有此證明，執行的任何工作都將會收取費用。請保留您的收據或是送貨單。
- 所有維修皆由戴森或其授權代理提供。
- 所有維修時換掉的零件皆為戴森財產。

重要資料保護

您註冊戴森產品或是 Dyson Link 應用程式時，將需要提供我們基本的聯絡資訊。

註冊戴森產品時：

- 您將需要提供我們基本的聯絡資訊，以註冊產品並讓我們得以支援您的保固。

透過 DYSON LINK 應用程式註冊時

您將需要提供我們基本的聯絡資訊，以註冊 Dyson Link 應用程式，這將可讓我們安全地將產品連結至應用程式的執行個體。

- 您註冊時，將有機會選擇是否要接收我們的訊息。如果您選擇加入接收戴森的消息，我們將傳送特殊優惠的詳細資訊以及最新產品的訊息。

符合性資訊

- 本產品符合臺灣低功率電波輻射性電機管理辦法第十二條、第十四條條文規定：
 - 第十二條 經型式認證合格之低功率射頻電機，非經許可、公司、商號或使用者均不得擅自變更頻率，加大功率或變更原設計之特性及功能。
 - 第十四條 低功率射頻電機之使用不得影響飛航安全及干擾合法通信；經發現有干擾現象時，應立即停用，並改善至無干擾時方得繼續使用。
- 前項合法通信，指依電信規定作業之無線電信。低功率射頻電機須忍受合法通信或工業、科學及醫療用電波輻射性電機設備之干擾。

限用物質含有情況標示

MARKING OF THE PRESENCE CONDITION OF THE RESTRICTED SUBSTANCES

設備名稱 EQUIPMENT NAME		型號 (型式) TYPE DESIGNATION : TP06				
單元 UNIT	限用物質及其化學符號 RESTRICTED SUBSTANCE AND ITS CHEMICAL SYMBOL					
	鎘 (Cd) Cadmium	鉛 (Pb) Lead	汞 (Hg) Mercury	六價鉻 (Cr ⁶⁺) Hexavalent Chromium	多溴聯苯 (PBB) Polybrominated biphenyls	多溴二苯醚 (PBDE) Polybrominated diphenyl ethers
外殼·機身 EXTERNAL CHASSIS, BODY	○	○	○	○	○	○
內部電線及電源線 INTERNAL WIRE & CABLE	○	○	○	○	○	○
泡棉材料 FOAM MATERIALS	○	○	○	○	○	○
螺絲及螺母 SCREWS & NUTS	○	○	○	○	○	○
控制器及其部件 CONTROLLER & PARTS	○	○	○	○	○	○
印刷電路板及電子部件 PRINTED CIRCUIT BOARD & COMPONENTS	○	—	○	○	○	○
電機元件 MOTOR ASSEMBLY	○	—	○	○	○	○
電源適配器 POWER ADAPTER	○	—	○	○	○	○

備考1. “○” 係指該項限用物質之百分比含量未超出百分比含量基準值。

Note 1: “○” Indicate that the percentage content of the restricted substance does not exceed the percentage of reference value of presence

備考2. “—” 係指該項限用物質為排除項目

Note 2: “—” indicates that the restricted substance corresponds to the exemption

備考3. “超出0.1wt%” 及 “超出0.01wt%” 係指限用物質之百分比含量超出百分比含量基準值。

Note 3: “Exceeding 0.1 wt%” and “exceeding 0.01 wt%” indicate that the percentage content of the restricted substance exceeds the reference percentage value of presence condition

Dyson customer care

If you have a question about your Dyson machine, contact us via the Dyson website or call the Dyson Helpline with your serial number and details of where and when you bought the machine.

戴森客戶服務

如果您對戴森產品有任何疑問，請透過戴森網站聯絡我們，或撥打戴森服務專線，並提供產品序號及購買地點與時間等資訊。

HK

捷成消費品服務中心(香港)

pidcs@jebsen.com

(852) 2926 2300

香港九龍旺角太子道西193號新世紀廣場2座19樓1917-1920室

www.dyson.hk

SG

Dyson Customer Care

1800-3976674

www.dyson.com.sg

MY

Dyson Helpline

+603 7969 1313

dysoncs@dancom.com.my

A-11-P1 & Mezz, Jaya One, 72A Jalan University,

46200 Petaling Jaya. Selangor

www.dyson.my

TW

Dyson 消費者服務中心

service@hlh.com.tw

0800 251 209

台灣區獨家總代理

恆隆行貿易股份有限公司

台北市內湖區洲子街 88 號 7 樓

www.dyson.tw